

# SAFETY KNIFE

## SECUMAX 145 MDP

ORDER NOW!

Order No.	145007.12
Knife size (L x W x H)	118 x 4 x 35.4 mm
Weight knife	13.7 g
Basic material	Metal detectable plastic



MAXIMUM  
SAFETY

**Concealed blade**  
for maximum protection of  
users and goods

**2-in-1 blade head**  
for cutting and  
piercing

**Metal detectable, ergonomic handle**  
for optimal detection

**4 mm cutting depth**  
for routine cutting tasks

**Guide surfaces**  
for easier angled cutting

**Practical eyelet**  
for a secure attachment

**2-cutting edge stainless  
steel blade (not changeable)**  
for a double period of use

ENJOY SAFETY  
MADE IN SOLINGEN

**martor**

# MARTOR SAFETY KNIFE SECUMAX 145 MDP

## SAFETY TECHNOLOGY



**SECUMAX**  
= maximum safety

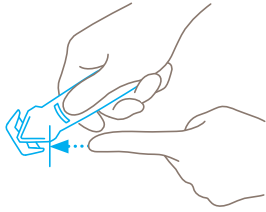

### Concealed blade

The SECUMAX 145 MDP blade is not an open one, but is hidden from people and goods. This provides you with a maximum degree of safety from cut injuries and from damage to goods.

## TECHNICAL FEATURES



Metal detectable



Disposable knife



Abrasion resistant



Ergonomic



2-cutting edge blade



Cutting depth



For right and left handers



Lanyard hole



Stainless

## EXAMPLES OF USE



## MAIN CUTTING MATERIALS



Cardboard: 1-ply



Wrapping, stretch and shrink foil



Tape



Bagged goods



Layers of foil or paper



Yarn, cord



Plastic strapping band

## MOUNTABLE BLADES

The stainless steel blade is moulded into the body of the knife and cannot be changed.  
Blade thickness 0.50 mm.

## PACKING INFORMATION

<b>Packaging unit</b>	10 in box (loose)
<b>Size Single unit box</b>	124 x 36 x 42 mm
<b>Weight single unit box</b>	151.0 g
<b>EAN Code single unit box</b>	4002632800665